

PHOENIX HOME & GARDEN

THE MAGAZINE OF SOUTHWEST LIVING

Saluting Arizona
Architecture

AIA Homes
of the Year

MERIT AWARD: Knoell & Quidort
Architects
Project: Edge of Phoenix Mountain
Preserve

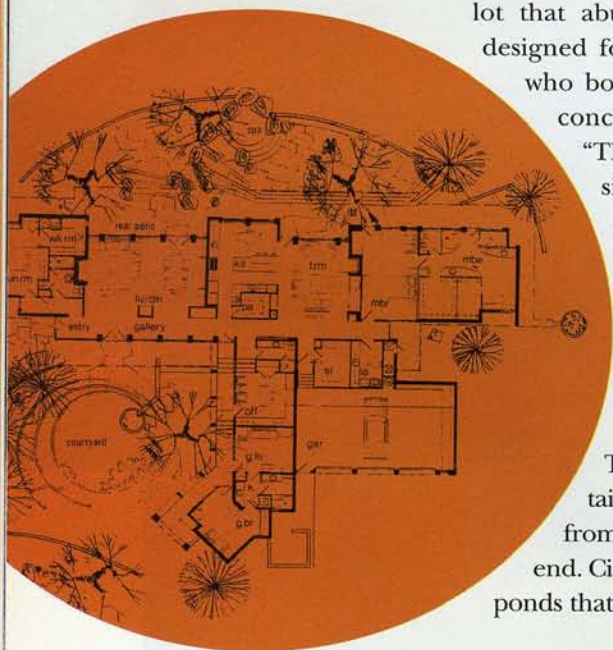

Description: This residence, which is situated on an acre lot that abuts the Phoenix Mountain Preserve, was designed for a couple who entertain frequently and who both work out of the home. The architects' concept statement reads, in part, as follows:

"The spaces of the home are located on the site to minimize disruption and maximize enjoyment of the setting. On the south, the house opens to the mountain and the natural desert environment. On the north, a walled courtyard provides a transition from public streets to domestic privacy.

"Architecture is integrated with landscape. The butterfly roof lifts up to capture mountain views. It also harvests rainwater, which flows from long scuppers to concrete cisterns at each end. Cisterns are fountains when it rains and holding ponds that slowly release water to planting areas."

Other distinguishing characteristics include curved masonry walls in colors reflecting nearby rock outcroppings, deep overhangs, and bands of quartzite stone, which cover structural joints in the concrete. Reinforcing the connection of the home with its setting, exterior materials are repeated inside, producing a smooth transition.



Interior design by Sandra Evans, Knoell & Quidort Architects
Construction by Schultz Development